

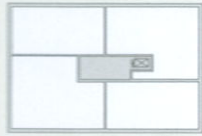

HAUS A

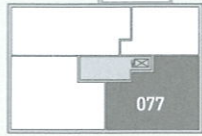

HAUS C



HAUS B

**Gesamtwohnfläche**

**120,0 m<sup>2</sup>**

Wohnen / Essen / Kochen

30,0 m<sup>2</sup>

Schlafen

19,0 m<sup>2</sup>

Kind 1

15,6 m<sup>2</sup>

Kind 2

15,6 m<sup>2</sup>

Bad 1

8,3 m<sup>2</sup>

Bad 2

4,9 m<sup>2</sup>

Diele

18,5 m<sup>2</sup>

Kammer

3,0 m<sup>2</sup>

Hauswirtschaftsraum

3,1 m<sup>2</sup>

Loggia 1/2  
(gesamt)

2,0 m<sup>2</sup>  
(4,0 m<sup>2</sup>)

